



**MUNICIPAL DISTRICT OF SPIRIT RIVER NO. 133  
IN THE PROVINCE OF ALBERTA**

**BYLAW #01-AM-15**

**BEING A BYLAW TO AMEND BYLAW 03-2009 THE LAND USE BYLAW OF THE  
MUNICIPAL DISTRICT OF SPIRIT RIVER #133**

---

**WHEREAS** the Council of the Municipal District of Spirit River #133, in the Province of Alberta has adopted A Land Use Bylaw 03-2009, and

**WHEREAS** the Council has the authority under the provisions of the Municipal Government Act, R.S.A. 2000, Chapter M-26 Revisions and Consolidation of Bylaws, Revision authorized, Section 63-2(h) with amendments thereto, to make amendments to its Land Use Bylaw,

**WHEREAS** the Council of the Municipal District of Spirit River #133 deems it desirable to amend the Land Use Bylaw No. 03-2009; now

**THEREFORE** the Council of the Municipal District of Spirit River #133, duly assembled, **HEREBY ENACTS AS FOLLOWS:**

1. **THAT** the land use district classification for the **Northeast three (3) Township Seventy-nine (79) Range Five (5) West of the Sixth Meridian (W6M)** be amended from **Agriculture (A)** to **Country Residential 1(CR1) District** as illustrated on Schedule "A" attached hereto.
2. **THAT** this bylaw shall come into force and take effect upon the Third and Final Reading thereof

READ A FIRST TIME this 6th day of May , A.D., 2015

READ A SECOND TIME this 10th day of June, A.D., 2015

READ FOR A THIRD AND FINAL TIME this 10th day of June, A.D., 2015

SIGNED by the REEVE and the CHIEF ADMINISTRATIVE OFFICER this  
10th day of June, 2015

  
\_\_\_\_\_  
Reeve Stanley Bzow

  
\_\_\_\_\_  
CAO Kelly Hudson

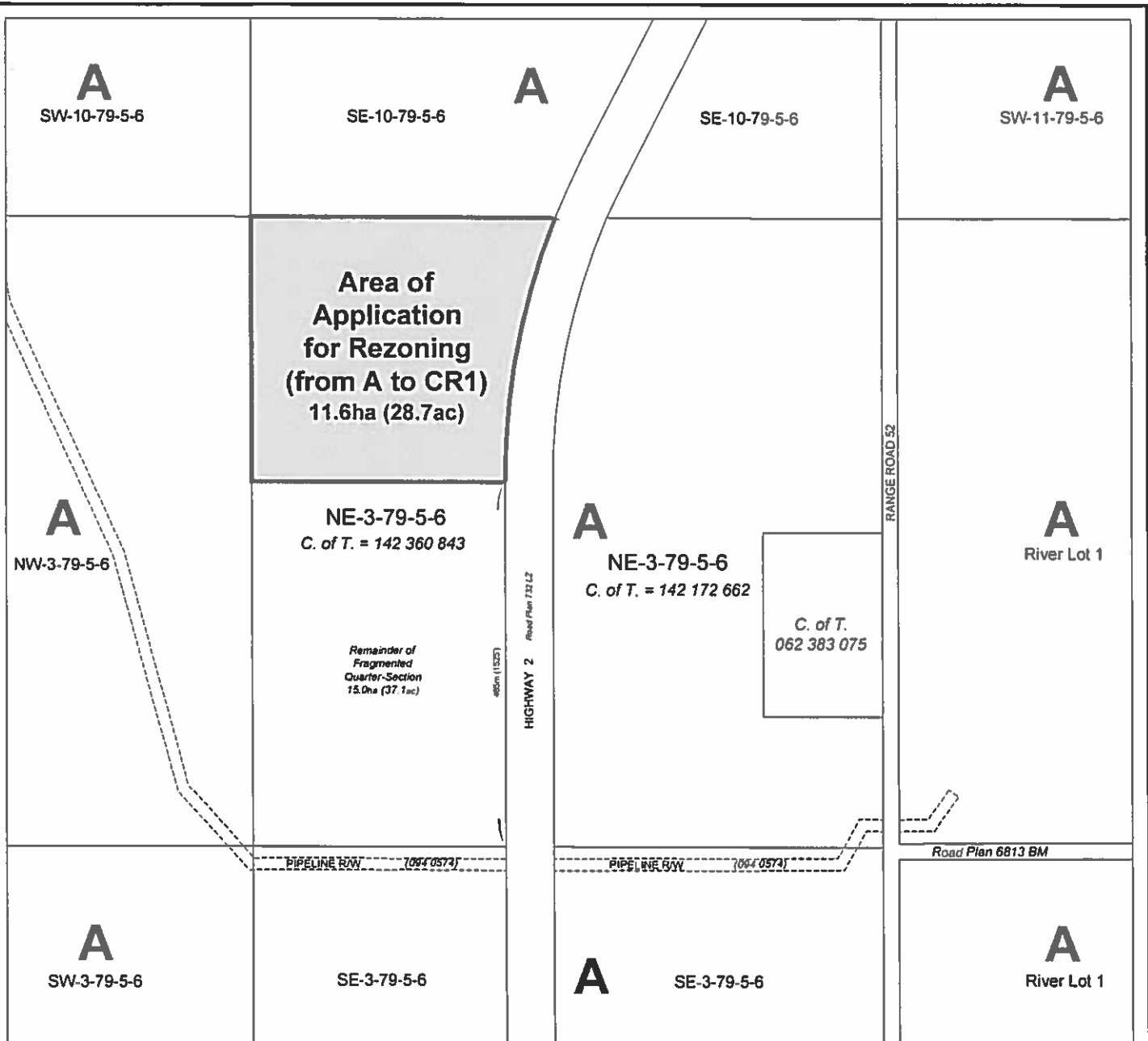

# PROPOSED LAND USE BYLAW AMENDMENT

AGRICULTURE (A) DISTRICT to  
 COUNTRY RESIDENTIAL 1 (CR1) DISTRICT  
 MUNICIPAL DISTRICT OF SPIRIT RIVER No. 133

LEGAL: NE Sec. 3, Twp. 79, Rg. 5, W6M

BYLAW No. 01-15

'Schedule A'



**A** Agriculture  
**CR1** Country Residential 1

Scale 1 : 7500

NOTE : Distances and area calculations are approximate (±). Improvements located as per data supplied by owner.

April 28, 2015

I:\13100\13110\_and\_spiritriver\_planning\02\_drafting\20\_drafting\2015\01-am-15\_margieet\01-am-15\_margieet\_schetch.dwg