



**MUNICIPAL DISTRICT OF SPIRIT RIVER NO. 133  
IN THE PROVINCE OF ALBERTA**

**BYLAW #02-AM-16**

**BEING A BYLAW TO AMEND BYLAW 03-2009 THE LAND USE BYLAW OF THE  
MUNICIPAL DISTRICT OF SPIRIT RIVER #133**

---

**WHEREAS** the Council of the Municipal District of Spirit River #133, in the Province of Alberta has adopted A Land Use Bylaw 03-2009, and

**WHEREAS** the Council has the authority under the provisions of the Municipal Government Act, R.S.A. 2000, Chapter M-26 Revisions and Consolidation of Bylaws, Revision authorized, Section 63-2(h) with amendments thereto, to make amendments to its Land Use Bylaw,

**WHEREAS** the Council of the Municipal District of Spirit River #133 deems it desirable to amend the Land Use Bylaw No. 03-2009; now

**THEREFORE** the Council of the Municipal District of Spirit River #133, duly assembled, **HEREBY ENACTS AS FOLLOWS:**

1. **THAT** the land use district classification for the **Southeast Twenty-three (23) Township Seventy-nine (79) Range Five (5) West of the Sixth Meridian (W6M)** be amended from **Agriculture (A)** to **Country Residential 1(CR1) District** as illustrated on Schedule "A" attached hereto.
2. **THAT** this bylaw shall come into force and take effect upon the Third and Final Reading thereof

READ A FIRST TIME this 7th day of September, A.D., 2016

READ A SECOND TIME this 5th day of October, A.D., 2016

READ FOR A THIRD AND FINAL TIME this 5th day of October, A.D., 2016

SIGNED by the REEVE and the CHIEF ADMINISTRATIVE OFFICER this 5th day of October, A.D., 2016

  
\_\_\_\_\_  
Reeve Stanley Bzowy

  
\_\_\_\_\_  
CAO Kelly Hudson

I:\131001\13110\_mnd\_spiritriver\_planning\02\_cad\120\_drafting\203\_subdivisions\2016\07-SD-16\_marpinet\07-SD-16\_marpinet\_sketch.dwg

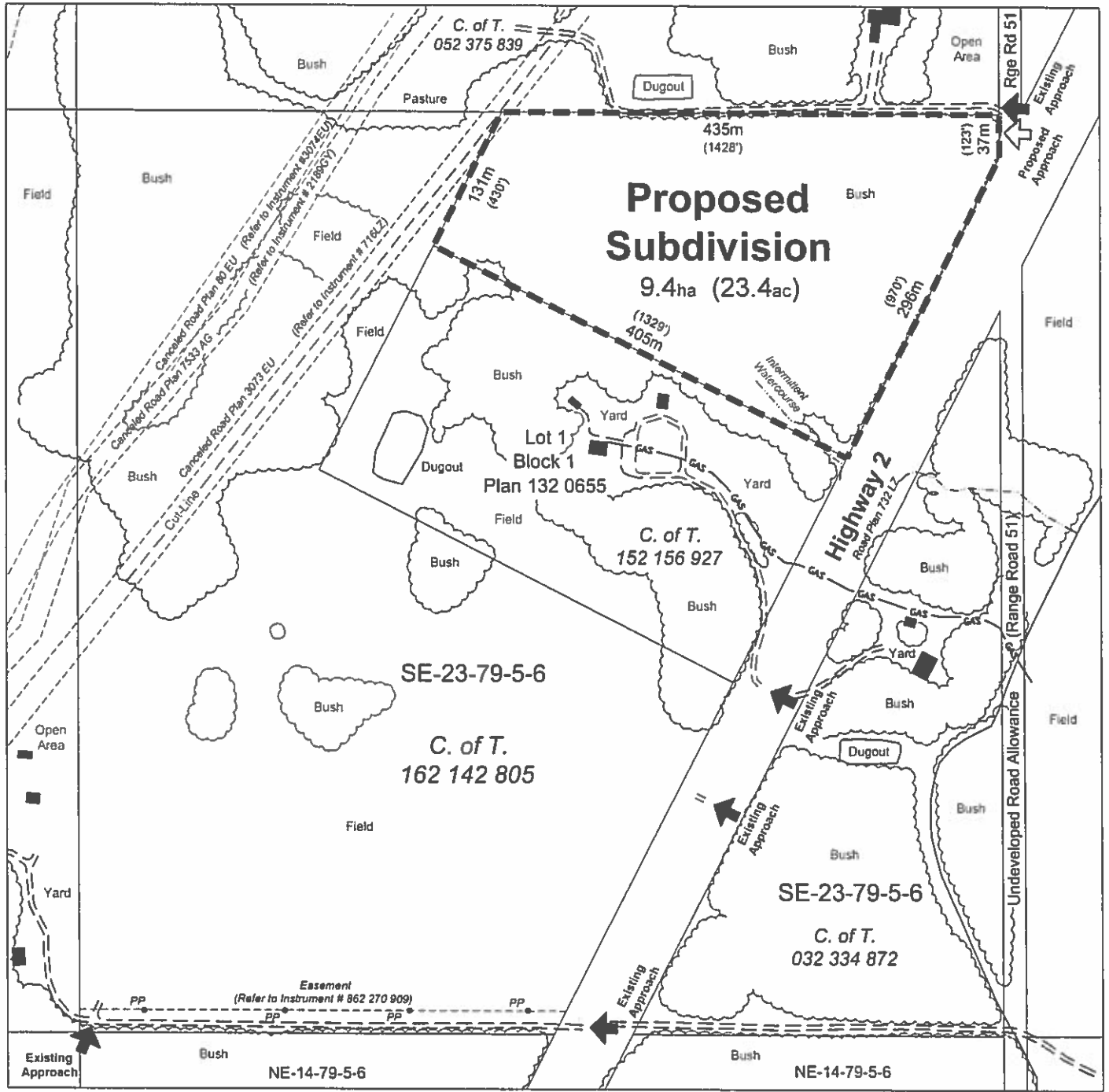

**PROPOSED PLAN OF SUBDIVISION**  
**MUNICIPAL DISTRICT OF SPIRIT RIVER No. 133**  
**LEGAL: SE Sec. 23, Twp. 79, Rg. 5, W6M**  
**FILE No. 07-SD-16**



- Legend**
- Building
  - Access Road
  - PP Power Pole

SCALE 1 : 5,000

NOTE : Distances and area calculations are approximate (±)  
 Improvements located as per data supplied by owner.

August 30, 2016